

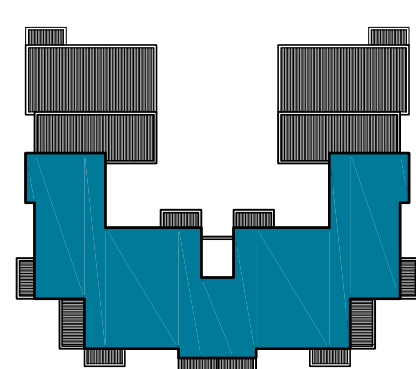

Third Floor Plan  
Scale 1:200



Second Floor Plan  
Scale 1:200



Type 'D' [Total Area = 4,377.1 m<sup>2</sup>]

- 8 no. 1-bed [55.3 m<sup>2</sup>]
  - 4 no. 1-bed [56.8 m<sup>2</sup>]
  - 2 no. 1-bed [58.6 m<sup>2</sup>]
  - 26 no. 2-bed [79.7 m<sup>2</sup>]
  - 2 no. 2-bed [100.5 m<sup>2</sup>]
- Apartment nos. 7, 14, 20, 26, 30, 34, 38 & 42  
 Apartment nos. 2, 9, 15 & 21  
 Apartment nos. 37 & 41  
 Apartment nos. 3, 4, 5, 6, 10, 11, 12, 13, 16, 17, 18, 19,  
 22, 23, 24, 25, 27, 28, 29, 31, 32, 33, 35, 36, 39, 40  
 Apartment nos. 1 & 8

Revision	Description	Date
2021	<b>GLEESON MCSWEENEY</b>	
Project Proposed residential development of Ballykeeffe, Raheen, Limerick. For: DW Raheen Developments Ltd.		Stage <b>Planning</b>
Title Apartment Building Type D - Floor Plans		Sheet 2 of 3
Scale 1:200 @ A1	Date December 2021	Drg No. <b>1704-10-127</b>
Drawn M.M.	Rev	99 O'Connell St., Limerick info@gleesonmcsweeney.ie
T 061 412277 E info@gleesonmcsweeney.ie		

ARCHITECTS